

## Intelligent sweeping robot Jichenbao

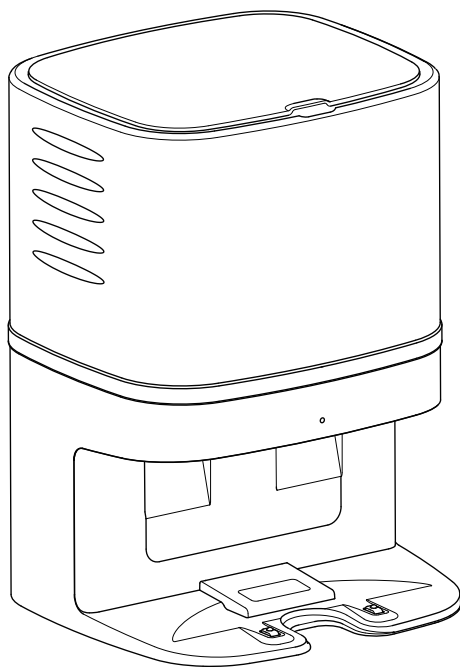

## User Manual

(Note: Please refer this manual carefully before use to avoid danger or damage to this product due to improper operation)

# Catalog

---

## 1. Security Instructions

## 2. Product Composition

- 2.1 Accessories Name
- 2.2 Product Parameters

## 3. User Instruction

- 3.1 Operational Guidelines
- 3.2 Product Maintenance

## 4. Alternative Modules

# Security Instructions

---

**Please read the below safety instructions and follow all routine safety precautions before using this product**

Please read this instruction carefully and keep it. Any operation inconsistent with this instruction may cause damage to the product

## Safety precautions related to main body and accessories

### Warning

01. Do not disassemble, repair or modify the machine individually to avoid product damage and Danger happen.
02. Don't use this product in an environment where there is a risk of fire or explosion.
03. This product can only use the original power adapter, otherwise it may cause damage to the product and fire.
04. It's forbidden to stand or sit on this product, since it may cause damage or fall of it.
05. When dust is attached to the metal part of the power plug, pls. make sure to wipe it with a dry cloth.
06. The power supply uses 100-240 V AC voltage, please insert the plug into the socket correctly to avoid child contact.
07. It's forbidden to wash and soak the mainframe and electronic components, otherwise it will cause short circuit damage.
08. Do not damage the processing power cord, don't put heavy objects on the power cord, heat, pull or bend it .
09. This product is an indoor household item. Do not use it outdoors.
10. It's forbidden to touch the battery contacts with any metal and conductive materials, otherwise it may cause short circuit.

### Attention

01. Don't touch it with wet hands, otherwise it may cause electric shock.
02. Do not place this product on easy-to-drop places, such as high platforms on table ,chair and rooms.
03. This product is a precision electronic device. Avoid prolonged exposure to sunlight.
04. Don't use this product in wet environments, such as bathrooms.
05. Don't place this product near cigarette butts, lighters and other open flames.
06. Please clean the product after charging. When the garbage bag is full, please replace it. Otherwise, the machine will be damaged or unusable.
07. Please unplug the power cord when not using this product for a long time.
08. Please check carefully whether the power cord is connected to the socket before use well to avoid unusable situation.

## Product Composition

---

### 2.1 Accessories Name

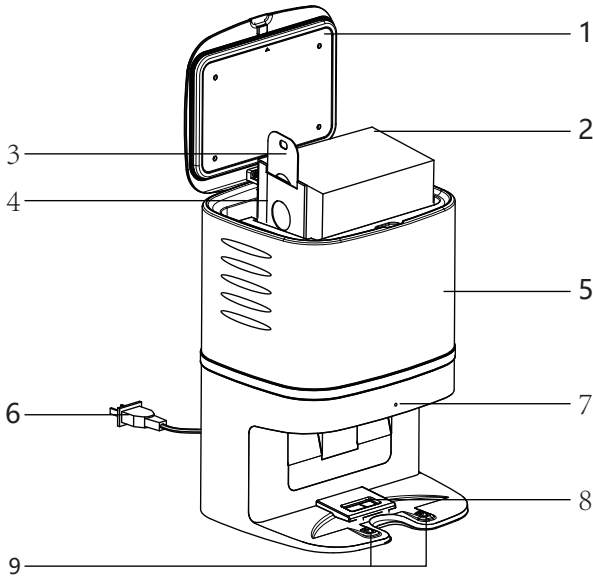

- |                 |              |                    |                         |
|-----------------|--------------|--------------------|-------------------------|
| 1.Lid           | 2.Dust bag   | 3.Dust bag handle  | 4.Dust bag guide plate  |
| 5.Body          | 6.Power cord | 7.Status indicator | 8.Dust box suction port |
| 9.Charging port |              |                    |                         |

## Product Composition

---

### 2.2 Product Parameters

#### Structure

Main body size	235*245*345mm
Main body Net weight	3.1kg

#### Electronics

Input voltage	100-240V ~ 50/60Hz
Output voltage	19V

#### Accessories

Dust bag capacity	2.8L
Dust bag size	170*130*130mm

## User Instruction

### 3.1 Operational Guidelines

#### Place Jichenbao

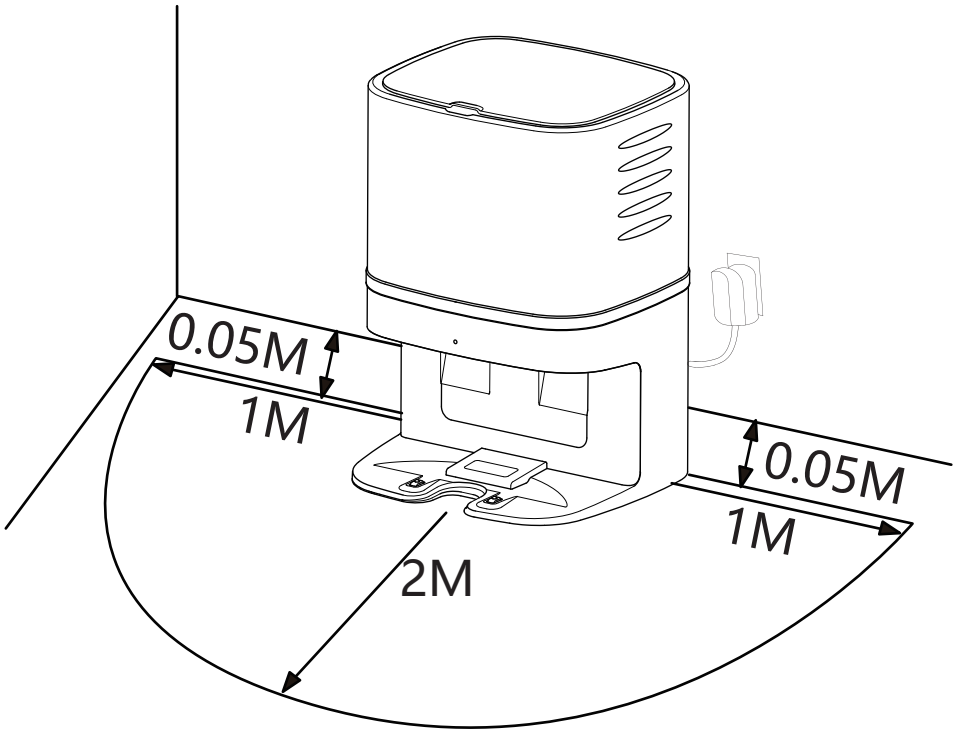

Lay Jichenbao flat, with a distance of 5cm from the back to the wall, no objects within 1M from left or right and 2M to front, and no objects with strong reflective surfaces such as mirrors.

Reminder: Please make sure the dust bag is installed properly in the first time.

## User Instruction

---

### 3.2 Product Maintenance

Place dust bag

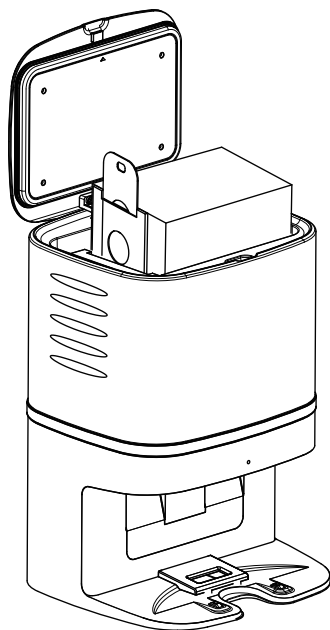

Open the lid of Jichenbao, insert the dust bag guide plate into the dust bag card position of Jichenbao, The handle of the dust bag should be fully inserted into the dust bag guide plate, and the lid should be closed.

## User Instruction

---

### Replace dust bag

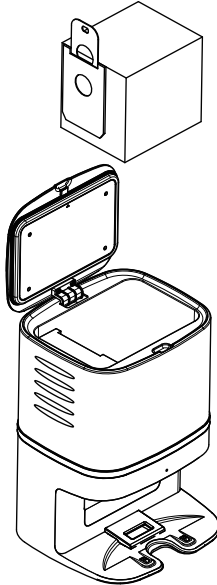

Open the lid of Jichenbao, pinch the handle of the dust bag and pull it upwards, causing the dust bag to separate from Jichenbao. Then follow the steps of placing the dust bag to replace a new bag.

### Indicator light instruction

Fast flashing red light indicates that the dust bag is not installed properly.  
Slowly flashing red light indicates that the suction pipe is blocked, pls. check whether the handle of the dust bag is inserted in place.  
The steady white light indicates that the dust is collecting.  
The quick flashes of white light to indicate the completion of dust collection.  
Slow flashing white light indicates that Jichenbao is available or charging the robot.



## Alternative Modules

---

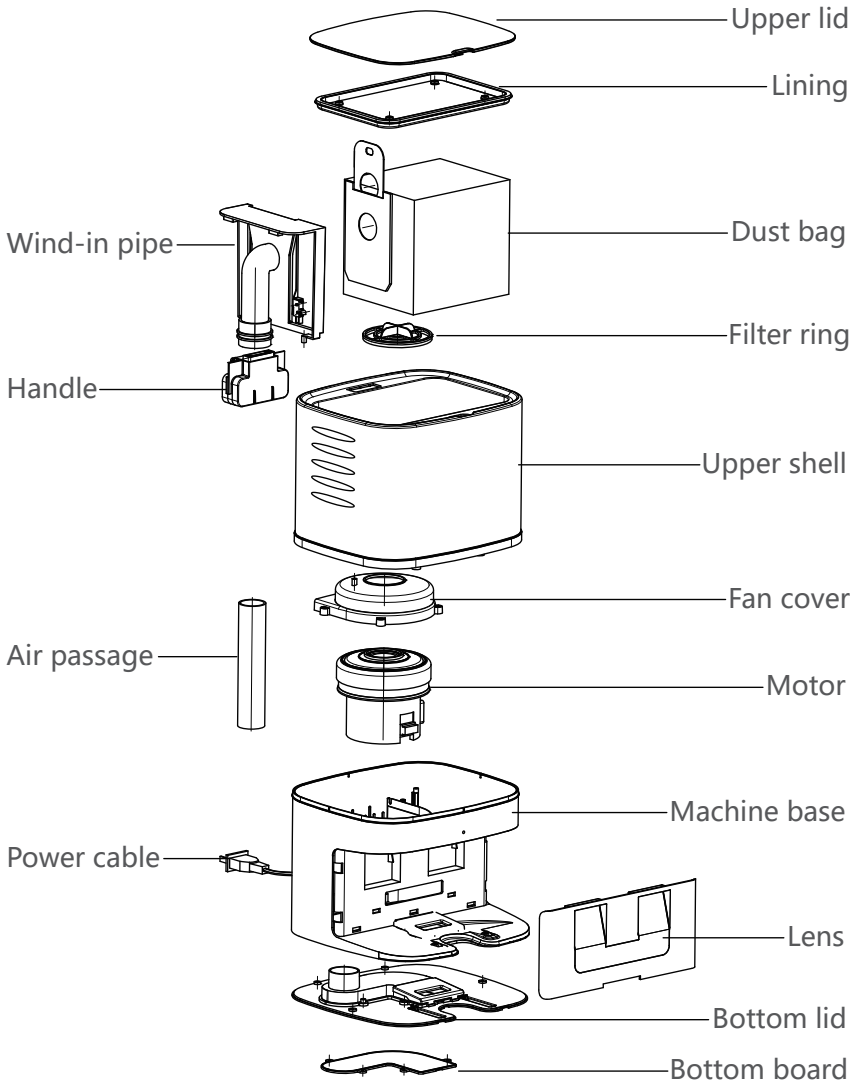

## **Your Partners For a Cleaner Home**

Importer: INVEO TRADE S.L

Address: Calle Castaño, 1, 28942 Fuenlabrada, Madrid , Spain

Manufacturer: Hangzhou Jumei E- commerce Co.,Ltd

Address: Room 301, 3rd Floor, Building 6, No. 212, Zhenhua Road,  
Xihu District, Hangzhou City, Zhejiang Province

[www.neatsvor.com](http://www.neatsvor.com) [service@neatsvor.com](mailto:service@neatsvor.com)

---